



THE NEW CHAPTER OF
Happiness



Builders & Developers :

TIMELINE INFRATECH PVT. LTD.

Office Address : Opposite Gola Road Petrol Pump, Ramjaipal More, Above Aadya Ceramics (Jaquar Showroom), Rupaspur, IAS Colony, Patna 801503.
E-Mail : info@timelineinfratech.com , Website : www.timelineinfratech.com

FOR BOOKING CONTACT : 7992242122

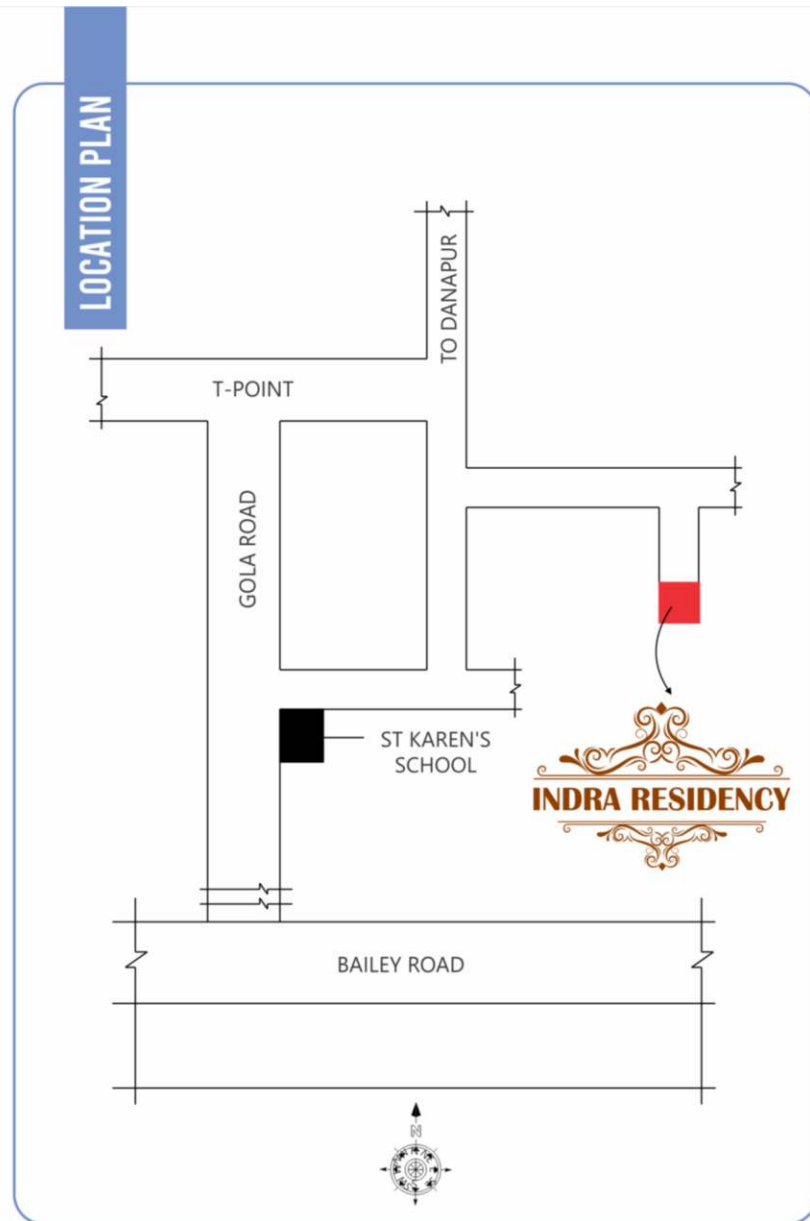

Architects :



archimetrics

DESIGN CONSULTANCY
Mobile : 99396 04962, Email : arajitsingh@gmail.com

@95045 66003

All rights are reserved with the developer/architect to make any changes in the plan & specification. This is a conceptual presentation & not a legal offering. All the shown photographs are illustrative only. Image is used in brochure solely for representational purpose. Designer & Printer does not hold any responsibility.



A HOME FULL OF
Happiness
AND FULL OF *Joy*

INDRA RESIDENCY

A Project By:
TIMELINE
INFRATECH

TYPICAL FLOOR PLAN

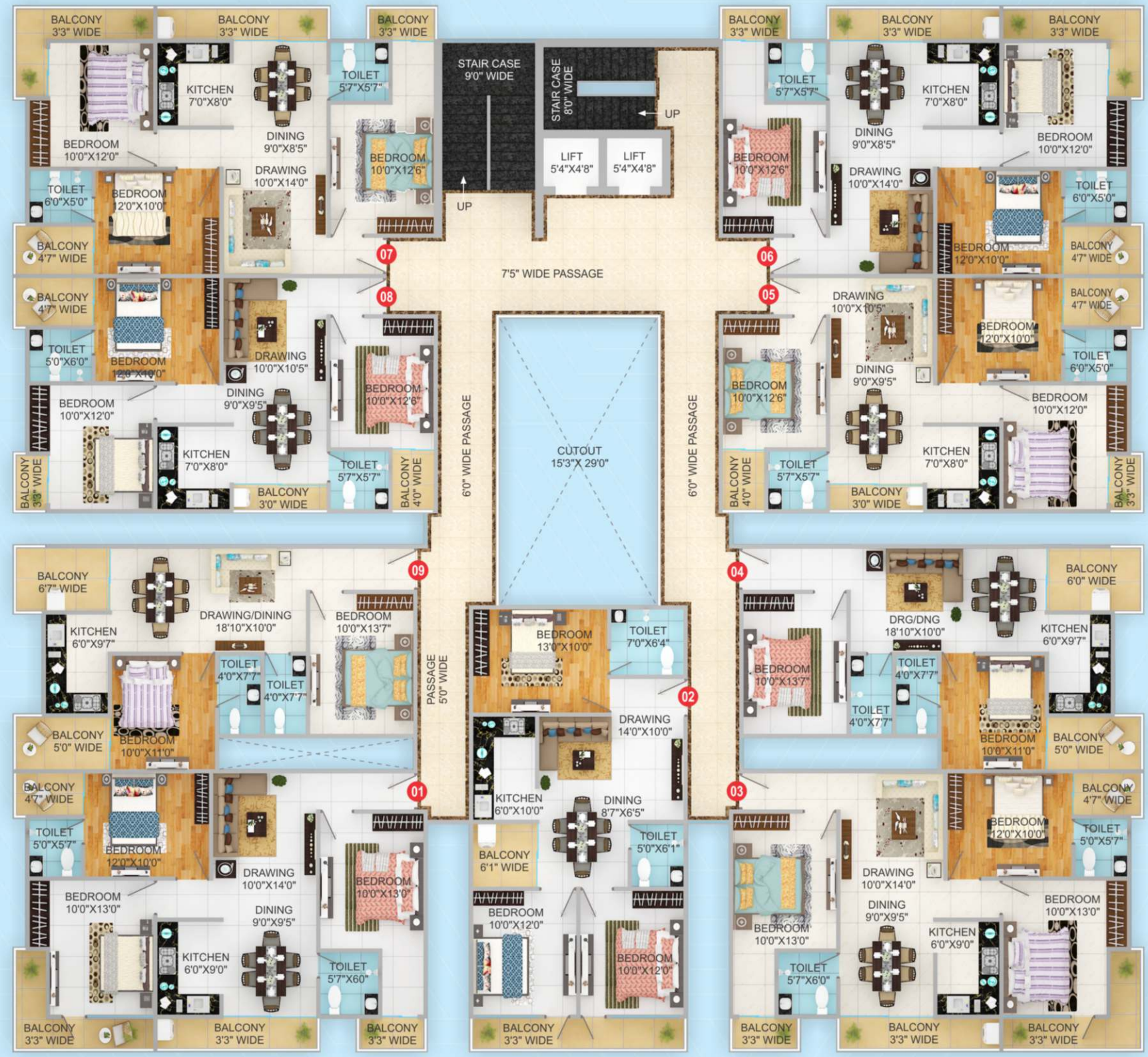

GROUND FLOOR PLAN



SPECIFICATIONS

- Foundation : R.C.C. frame structure building as per the design of structural engineers.
- Wall : Internal wall shall be finished with wall putty & external wall finished with texture paint as per design.
- Door : Main door Sal Wood frames and water proof flush doors with decorative front side laminate/door skin, internal wooden chowkhat painted with two coat of enamel paints.
- Window : Wooden frames and shutters with 3mm clear glass window or UPVC / Aluminium with Glass.
- Flooring : Vitrified tiles from reputed brands like Kajaria, Somany, equivalent brand.
- Kitchen & Toilets: Granite (Black/Pink) platform with stainless steel sink of ISI mark. Glazed tiles dado up to 2 feet above the platform. Exhaust fan space in window. Aqua guard, Microw-wave point in kitchen.
- Toilets : Ceramic anti skid tiles of Kajaria, Somany

TYPICAL FLOOR - AREA STATEMENT

FLAT NO.	TYPE	S./B.UP AREA
01	3 BHK	1345 SQ. FT.
02	3 BHK	1300 SQ. FT.
03	3 BHK	1345 SQ. FT.
04	2 BHK	1040 SQ. FT.
05	3 BHK	1165 SQ. FT.
06	3 BHK	1320 SQ. FT.
07	3 BHK	1320 SQ. FT.
08	3 BHK	1165 SQ. FT.
09	2 BHK	1040 SQ. FT.

GROUND FLOOR - AREA STATEMENT

FLAT NO.	TYPE	S./B.UP AREA
02	2 BHK	850 SQ. FT.
06	3 BHK	1250 SQ. FT.
07	3 BHK	1250 SQ. FT.

- Electrical : High quality insulated copper wiring with Modular switches branded company like Havells, Goldmedal, Anchor or equivalent make.
- TV/Telephone : Telephone points in drawing room & master bedroom. Cable TV point in all bedroom & drawing room.
- Intercom : Provision of Intercom with one nos. Hand set to each flat.
- Security System : Provision CCTV for common area of campus.
- Fire Fighting System: As per norms.
- Lifts : Two lifts of Otis / Kone /Mitsubishi / Thyssen Krupp, Eletek or equivalent ISI make in each block.
- Generator : Silent generator Kirloskar or equivalent brand of adequate capacity.

FEATURES



PAYMENT PLAN

- At the time of booking - 10%
- Withing 7 days of execution of agreement for sale - 25%
- At the time of plinth level completed - 10%
- Casting of ground floor roof - 10%
- Casting of first floor roof - 10%
- Casting of second floor roof - 10%
- Casting of third floor roof - 10%
- On completion of brickwork - 5%
- On completion of internal and external wall plaster - 5%
- At the time of possession - 5%

